

THE CITY OF NAPOLEON

BUILDING & ZONING DEPARTMENT

255 W. RIVERVIEW

(419)592-4010

Building Permit

Permit Number: BP2006-34

Page 1 of 1

Printed: 4/12/2006

Property Address: 55 Lemans Dr

Applicant

Approval Date: 4/12/2006

Address: Jeff & Diana Parker
55 Lemans Dr
Napoleon, OH 43545

Phone: 419-599-0119

Owners

Name: Mr. Jeff & Diana Parker
55 Lemans Dr
Napoleon, OH 43545

Phone: 419-599-0119

Contractors

Fees and Receipts:

Number	Description	Amount
FEE2006-279	Building Permit Fee (Auto)	\$10.00
Total Fees:		\$10.00
RCPT2006-116		\$10.00

Description

Structure Use:

Start Date:

Construction Value: \$900.00

End Date:

Floor Areas: Living Space: Basement/Storage: Garage:

Description of work to be done:

Shed 8x12



Applicant signature: Diana Parker Date: 4-11-06

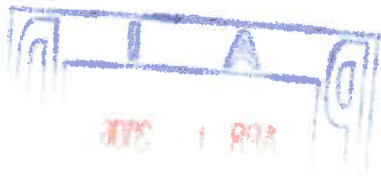

W
↑

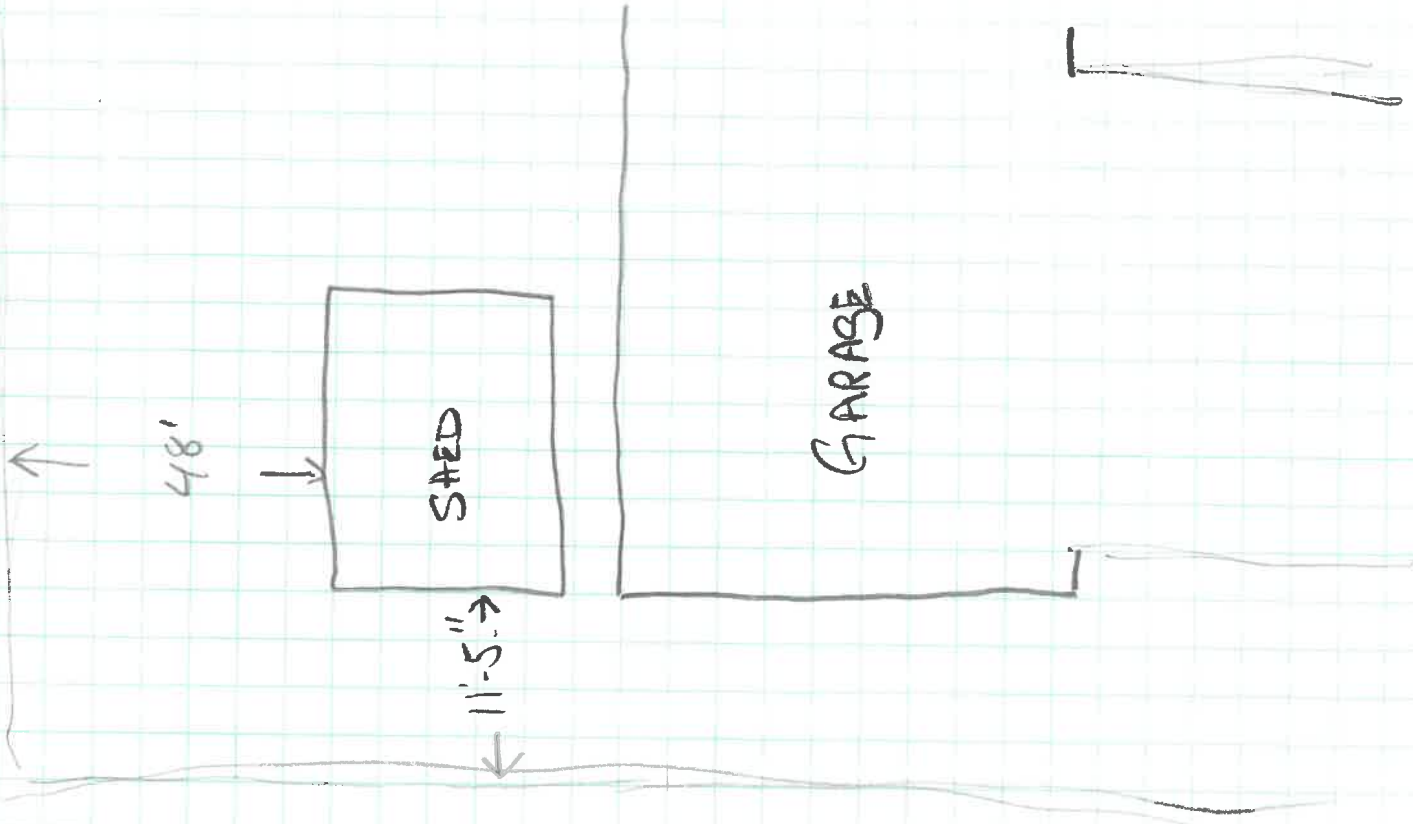

48'

SHED

11'-5"

GARAGE



THE CITY OF NAPOLEON

BUILDING & ZONING DEPARTMENT

255 W. RIVERVIEW

(419)592-4010

Fee Record

Fee Number: FEE2006-279

Page: 1

Date Printed: 4/12/2006

Fee Type: Building Permit Fee (Auto) **Amount:** \$10.00

Date: 4/12/2006

Charged To: Mr. Jeff & Diana Parker

Receipt #: RCPT2006-116

Charged By: Angela

Paid?

Reference #: BP2006-34

Account: Building Permits

Comments: ck 9639

Other Fields:

CITY OF NAPOLEON GENERAL PERMIT APPLICATION

THIS APPLICATION IS FOR RESIDENTIAL CONSTRUCTION INCLUDING BUILDING, ELECTRICAL, PLUMBING
MECHANICAL, DEMOLITIONS, REMODELING.

DATE: 4-11-06 JOB LOCATION: 55 Lemans Drive Napoleon

OWNER: Jeff + DIANA PARKER PHONE: 599-0119

OWNER ADDRESS: 55 Lemans Drive CITY: Napoleon ZIP: 43545

CONTRACTOR: _____

PHONE #: _____ CELL PHONE# _____

CONTRACTOR LICENSED WITH THE CITY OF NAPOLEON?: YES NO:

Is any of the above job going to be subcontracted out? Yes No:

If yes to whom: _____

DESCRIPTION OF WORK TO BE
PERFORMED: Shed

ESTIMATED COMPLETION DATE: _____

PLEASE MARK THE TYPE OF WORK YOU WILL BE PERFORMING

- | | |
|---|--|
| <input type="checkbox"/> A/C ADD ON | <input type="checkbox"/> REMODELING |
| <input type="checkbox"/> BOILER REPLACEMENT | <input type="checkbox"/> ROOFING |
| <input type="checkbox"/> CURBING | <input type="checkbox"/> SEWER REPAIRS** |
| <input type="checkbox"/> DECKS * | <input type="checkbox"/> SIDEWALK* |
| <input type="checkbox"/> DRIVEWAY* | <input type="checkbox"/> SIDING |
| <input type="checkbox"/> ELECTRICAL SERVICE UPGRADE | <input type="checkbox"/> STORAGE SHED* |
| <input type="checkbox"/> ELECTRICAL SERVICE NEW | <input type="checkbox"/> SWIMMING POOL* |
| <input type="checkbox"/> FENCE* | <input type="checkbox"/> FURNACE REPLACEMENT |
| <input type="checkbox"/> ADDITIONS* | <input type="checkbox"/> TEMP ELECTRIC |
| <input type="checkbox"/> FURNACE NEW | <input type="checkbox"/> WATER TAP (size _____") |
| <input type="checkbox"/> LAWN METER | <input type="checkbox"/> WINDOWS |
| <input type="checkbox"/> PLUMBING | <input type="checkbox"/> ZONING |

*PLEASE INCLUDE A PICTURE SHOWING MEASUREMENTS FROM EXISTING STRUCTURES AND
PROPERTY LINES. INDICATING THE TYPE OF WORK YOU WISH TO PERFORM.

** IF WORK REQUIRES GOING INTO THE STREET A STREET BOND IS REQUIRED!

FOR PERMIT COSTS PLEASE FILL OUT REVERSE SIDE

PERMIT COST WORKSHEET

<u>JOB</u>	<u>BASE FEE</u>	<u>TOTAL</u>
SIDING (only) TOTAL SQ _____ X 1.00 +	\$5.00 =	\$ _____
ROOFING (only) TOTAL SQ _____ X 1.00 +	\$5.00 =	\$ _____
WINDOWS (only) # OF WINDOWS ____ X 1.00 +	\$5.00 =	\$ _____
ELECTRICAL # OF CIRCUITS ____ X 3.00 +	\$15.00 =	\$ _____
ELECTRICAL SERVICE UPGRADE	\$15.00 =	\$ _____
PLUMBING (INSIDE) repairs only	\$10.00 =	\$ _____
PLUMBING/SEWER (OUTSIDE)	\$25.00 =	\$ _____
WATER HEATER	\$5.00	\$ _____
SHED UNDER 200 SQ FT	\$ 5.00	\$ _____
FURNACE OR A/C (REPLACEMNT)	\$ 5.00	\$ _____
DEMOLITION (only)	\$30.00	\$ _____
SIDEWALK REPLACEMENT/ NEW	\$25.00	\$ _____
DRIVEWAY	\$25.00	\$ _____

ALL CONSTRUCTION, ALTERATIONS, REMODELING, SHEDS, DECKS & FENCES NOT LISTED ABOVE IS BASED ON COST OF WORK BEING PERFORMED.

COST OF WORK \$ _____ (SEE CHART) \$ _____

0.00	-	250.00	0.00	11,000.00	-	11,999.00	25.00
250.00	-	1,000.00	10.00	12,000.00	-	12,999.00	26.00
1,000.00	-	1,999.00	12.00	13,000.00	-	13,999.00	27.00
2,000.00	-	2,999.00	14.00	14,000.00	-	14,999.00	28.00
3,000.00	-	3,999.00	16.00	15,000.00	-	15,999.00	29.00
4,000.00	-	4,999.00	18.00	16,000.00	-	16,999.00	30.00
5,000.00	-	5,999.00	19.00	17,000.00	-	17,999.00	31.00
6,000.00	-	6,999.00	20.00	18,000.00	-	18,999.00	32.00
7,000.00	-	7,999.00	21.00	19,000.00	-	19,999.00	33.00
8,000.00	-	8,999.00	22.00	20,000.00	-	20,999.00	34.00
9,000.00	-	9,999.00	23.00	21,000.00	-	21,999.00	35.00
10,000.00	-	10,999.00	24.00	22,000.00	-	22,999.00	36.00
				Over 22,999	Please Call		

City of Napoleon

BUILDING & ZONING DEPARTMENT

255 W Riverview

(419)592-4010

Inspection Record

Inspection #: INSP2006-185

Page: 1

Printed: 6/7/2006

Address: 55 Lemans Dr
Napoleon, OH 43545

Reference #: BP2006-34

Applicant: Mr. Jeff & Diana Parker

Directions To Parcel:

Inspection Type: Building Final

Date: 6/7/2006

Inspector: Tom

Status: Complete

Passed?

Required Steps:

Comments:

Inspection Checklist:

Corrections:

Correction Code:

Date:

Correction Description:

Status:

Correction Made Date:

Conditions:

Condition Code:

Description:

Date:

Department:

Status:

Other Fields:

